



SW500 SEWAGE PUMP

FEATURES

- Heavy duty cast iron
- Oil-filled continuous duty motor
- 2 vane cast iron semi-open impeller

***Honest
Professional
Dependable***

1899 Cottage Street, Ashland, Ohio 44805

Telephone: 855 281-6830 · Fax: 877 326-1994

ashlandpump.com



SW500 - 5 HP Submersible Sewage Pump

TECHNICAL DATA

Physical Data:

DISCHARGE SIZE **3" NPT**
 IMPELLER TYPE **2-Vane, Open - Cast Iron**
 CABLE LENGTH **20'**

Liquid Handling:

SOLIDS SIZE **3"**
 MAXIMUM LIQUID TEMP. **104°F - Intermittent**
 ACCEPTABLE PH RANGE **6-8**

Temperature:

MAXIMUM STATOR **130°C**

Technical Data:

POWER CORD TYPE **8/4C, 12/4C
12/4C**
 MOTOR HOUSING **Cast Iron**
 CASING **Cast Iron**
 IMPELLER **Cast Iron**
 MOTOR SHAFT **SUS420**
 HARDWARE **SST**
 "O" RINGS **NBR**
 SEALS **Single Mechanical,
Carbon Ceramic**
 UPPER BEARING **6203**
 LOWER BEARING **6206**

ELECTRICAL DATA

R.P.M. **1750**
 MOTOR TYPE **CSCR, Induction**
 GENERAL INSULATION CLASS **B**
 STATOR WINDING CLASS **B**
 MAXIMUM STATOR TEMPERATURE **130°C**
 VOLTAGE TOLERANCE **±10%**
 MOTOR PROTECTION **N/A**
 HP **5**
 VOLTAGE **230, 460**
 PHASE **1, 3**
 SERVICE FACTOR **1**
 FULL LOAD AMPS **45.6, 23.6, 11.8**

DIMENSIONAL DATA

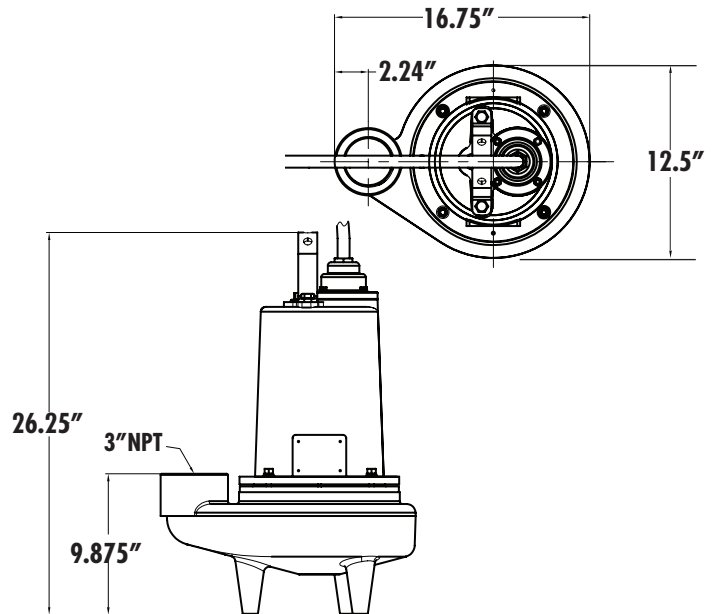

PERFORMANCE CURVE

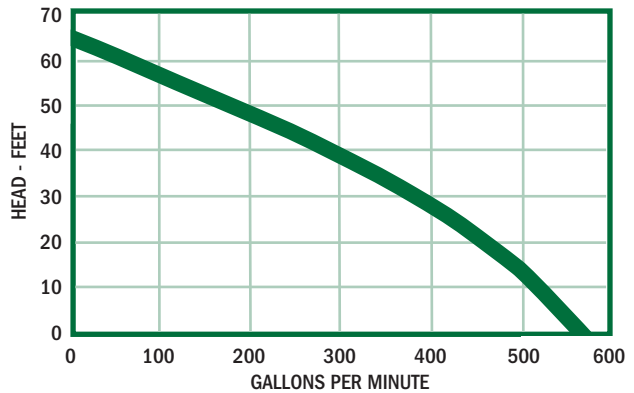

PERFORMANCE CHART

Total Lift(feet)	0	15	20	30	40	50	60	64
GPM	570	490	450	375	295	180	60	0



P U M P

Honest, Professional, Dependable

1899 Cottage Street, Ashland, Ohio 44805
 Telephone: 855 281-6830 · Fax: 877 326-1994 · ashlandpump.com